



# Mill Lane

Kislingbury, Northamptonshire

oriordanbond  
SALES & LETTINGS





## Mill Lane

Kislingbury  
NN7 4BD

Price  
£490,000

**Situated in the heart of the popular and quiet village of Kislingbury is this well presented three bedroom detached dormer bungalow set on a generous plot approaching a quarter of an acre.**

The accommodation comprises entrance hall, sitting room, refurbished kitchen, two double bedrooms, garden room and a re-fitted family bathroom. The first floor offers the master bedroom with useful eaves storage. Outside is a substantial rear garden with a patio seating area, lawn and a range of mature plants, bushes and shrubbery. To the front is off road parking for three vehicles and a garage. Further benefits include uPVC double glazing and gas radiator heating. (B/1186/L)

- Three bedroom detached dormer bungalow
- Refurbished kitchen and re-fitted bathroom
- Garden room
- Gas radiator heating
- Substantial rear garden on just under quarter of an acre
- Ample off road parking and garage









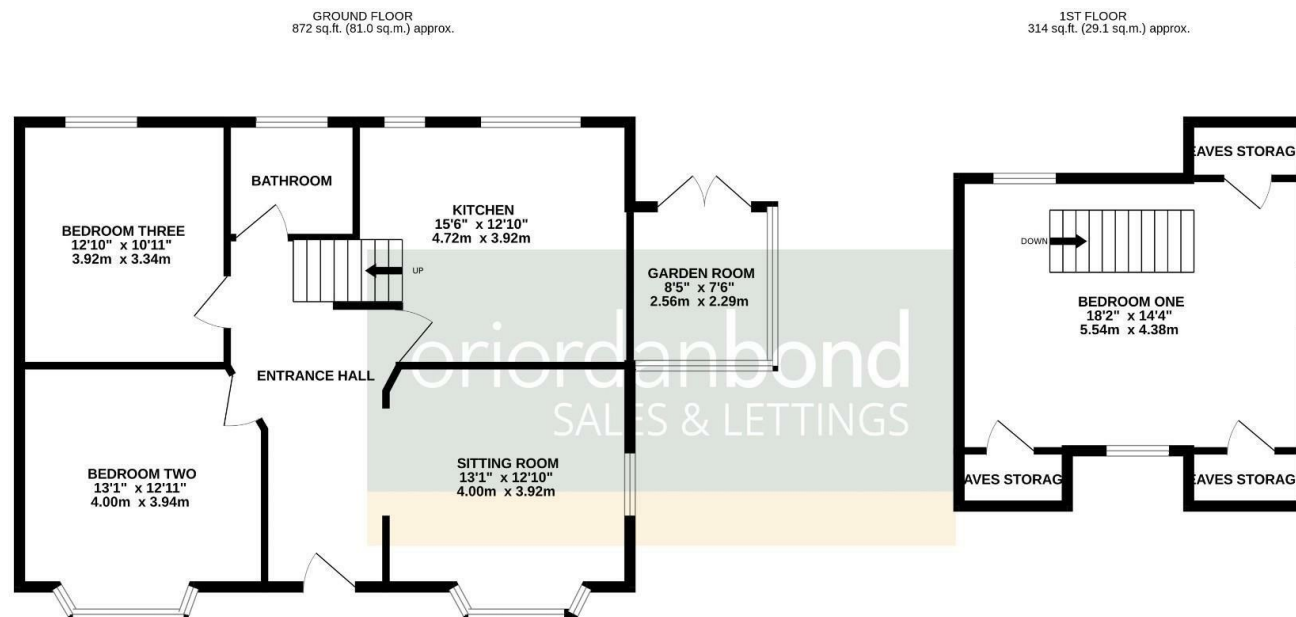

Whilst every attempt has been made to ensure the accuracy of the floorplan contained here, measurements of doors, windows, rooms and any other items are approximate and no responsibility is taken for any error, omission or mis-statement. This plan is for illustrative purposes only and should be used as such by any prospective purchaser. The services, systems and appliances shown have not been tested and no guarantee as to their operability or efficiency can be given.  
Made with Metropix ©2025



#### Additional information

- Council Tax Band: D
- Energy Efficiency Rating: E

#### Viewing

Viewing strictly by appointment – details below

#### Disclaimer

O'Riordan Bond Estate Agents Limited has not tested apparatus, equipment, fittings or services and so cannot verify they are in working order. The buyer is advised to obtain verification from their solicitor or surveyor.

**O'Riordan Bond Duston North Sales**  
**01604 589007**

dustonnorth@oriordanbond.co.uk

